

WASTE COLLECTION

FRONT END LOADER MOBILE COMPACTORS

Front End Loaders are vehicles designed for the collection of compactable industrial and commercial wastes. The compaction system is highly efficient and up to three times faster than conventional Rear End Loaders.

The system can facilitate various bin sizes ranging from 2m³ to 9m³, which are emptied into the Front End Loader on-site.

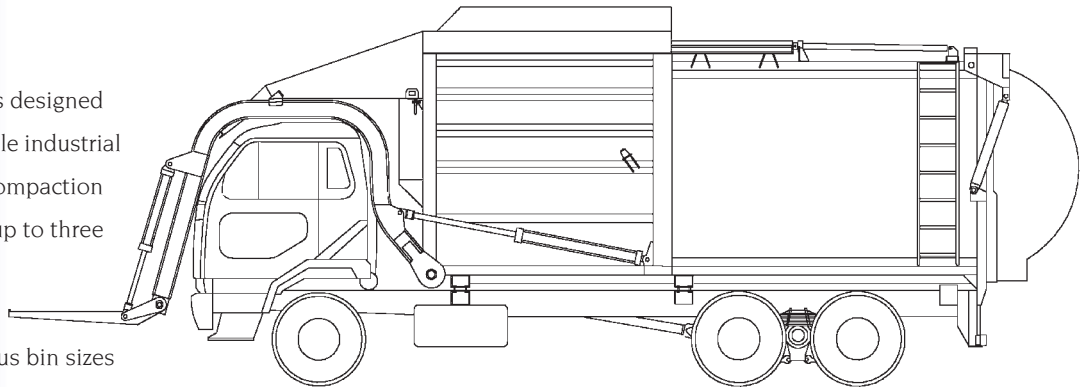

VEHICLE SPECIFICATIONS

Double Axle Unit

Maximum compacted volume	30m ³
Container capacities	2m ³ – 9m ³
Turning circle	20.3m
Vehicle height	4.2m
Vehicle width	2.5m
Vehicle length	11.0m

Please note that an additional allowance of 40% should be made for access purposes

CONTAINER SPECIFICATIONS

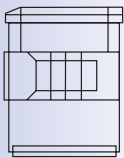

2m³ Bin

Length 2.05m x Width 0.96m x Height 1.20m
Construction material – 3mm mild steel
Application – restaurants, offices and mini-factories etc.

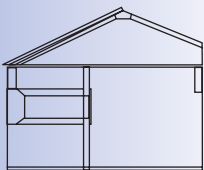

6m³ Bin

Length 2.20m x Width 2.05m x Height 1.80m
Construction material – 4mm mild steel
Application – medium volume industrial collections.

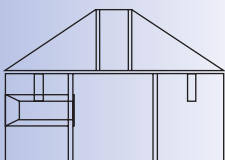

9m³ Bin

Length 2.98m x Width 2.05m x Height 2.33m
Construction material – 4mm mild steel
Application – high volume industrial collections.

NOTE: All containers are available with lids and wheels as an option.

For further information on our wide range of products and services or for details on our operational centres throughout southern Africa please contact Head Office.

e-mail: sales@interwaste.co.za • www.interwaste.co.za
National call centre: 0860 WASTE 0 • Tel: +27 011 792 9330 • Fax: +27 011 792 8998
PO Box 641 Northriding 2162 Republic of South Africa